

# WIDE MOUNT

Made in USA Patented 

**NO-PEST**  
*vent*



Dual door design  
**KEEPS PESTS  
OUT**

## BENEFITS THAT OTHERS CANNOT PROVIDE

### Closed position (not in operation)

- Birds and other pests cannot enter the “Exclusive Dual Door” design. Reduces energy robbing drafts from entering the residence through the vent. Clean look, fully closed design, no place for bees or wasps to nest.

### Maintenance - Annual duct cleaning recommended for safety

- Ducts can be cleaned with lint brush from either side.
- Makes multi-story cleaning possible from the inside without using ladders.
- Tough U/V resistant plastic resists sunlight and cracking.

### Open position (in operation)

- Most efficient air flowing vent in the industry for reduced clothes drying time. No screen or guard to collect lint, plug-up and reduce air flow efficiency. Reduces dryer fire hazard caused by lint buildup.

### Compare the No Pest Vent to the competition

- Vents with one-piece flap or 2 to 4 louvers
- Opening with their beaks, birds quickly build a nest for a well heated home
- Lint buildup causes unreliable louver closure allowing drafts and easier entry for pests
- Vents with screen, floating shuttle, or add-on guards for existing vents
- Require weekly or monthly cleaning of lint buildup
- Lint buildup restricts flow which reduces dryer efficiency and creates a fire hazard



# Most Efficient Maintenance Freet Vents on the market



The New Quick Collar to make  
Installs Even Easier!

## Features

- Our most popular product for replacement, but can be used for new Installation as well
- The larger face plate covers more of the former vent mounting area for a cleaner finished install
- Tough U/V stable material resists sunlight and cracking.
- The Wide Mount vent can be used for any dryer, bath-room, or range exhaust application
- Available with optional 4" diameter, 12" long snap fit duct pipe

**QUICK**  
*collar*®



ONLY AVAILABLE IN 4" MODEL

## STANDARD COLORS



White



Tan



Brown

## Premium COLORS



Onyx



Grey



Woodstock Brown



Deep Ocean Blue



Slate Grey

**NO-PEST**  
*vent*®

# 4" *WideMount*

## Technical Product Specification

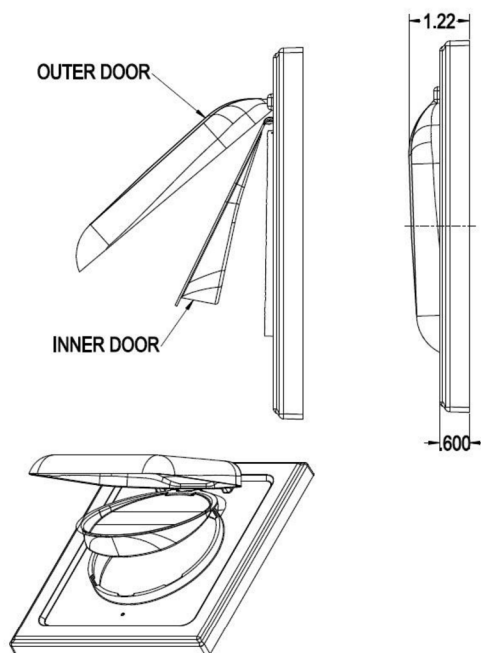
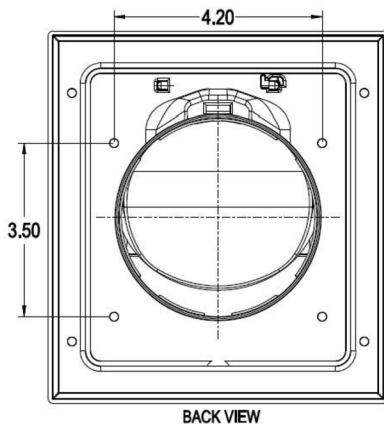
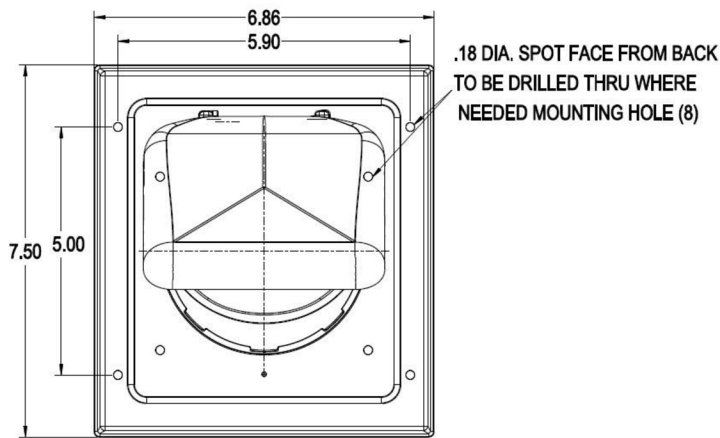

Model No.	Description	Color
4NPWMO- White	4" WideMount No Pipe	White
4NPWMO- Tan	4" WideMount No Pipe	Tan
4NPWMO- Brown	4" WideMount No Pipe	Brown
4NPWMO- Onyx	4" WideMount No Pipe	Onyx

\*Premium Colors Available in: WoodStock Brown, Light Grey, SlateGrey, andDeepOcean Blue\*

### Performance Data

#### Product Use:

- Dryer Exhaust Termination
- Bathroom Exhaust Termination
- Complies w/ IMC 504.4 & IRC 1502.3

#### Materials:

- USA Sourced 20% Talc Filled Polypropylene
- UV Inhibitor= 15,000 kJ/m2 before failure
- equal to 10-15 years in Florida sun
- Melting Point: Approx 325° F (163° C)

### General Information

#### Benefits:

- Blocks Birds and other pests from entering exhaust system without the use of cages or screens.
- Dual door design allows two back draft dampers eliminating the need for an additional back draft damper on the interior and completely seals system from outside air.
- Eight marked mounting holes for easy installation
- Low profile Design
- Dual Door has low back pressure differential and High Exhaust efficiency
- High Grade American Talc Filled Polypropylene

#### Features:

- Patented Dual Door Design
- Magnetic Door Retention

### Manufactured By:

#### P-tec Products, Inc

248 N Church St.  
Zeeland, MI 49464  
616-772-0659  
Nopestvent.com  
Home of the



# 6" **WIDE** Mount

## Technical Product Specification

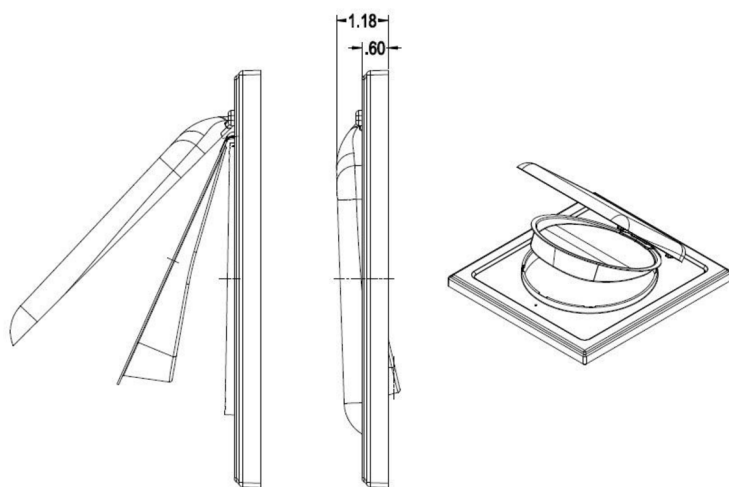
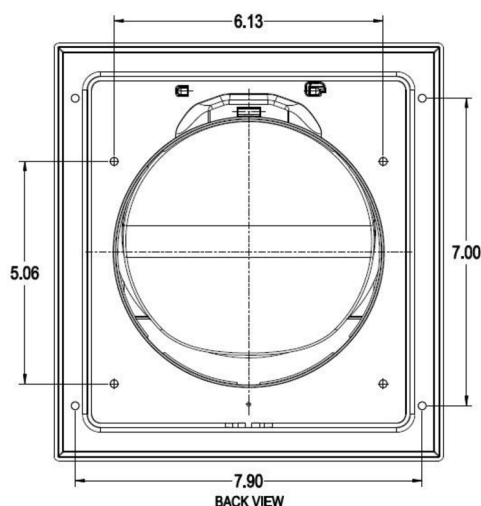
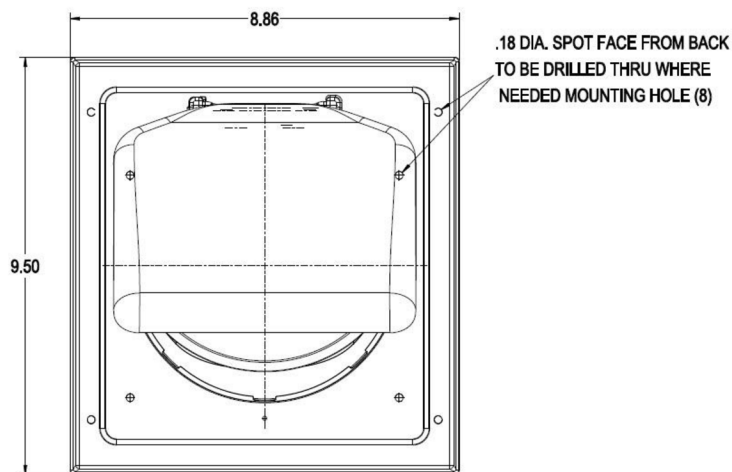

Model No.	Description	Color
6NPWMO- White	6" WideMount No Pipe	White
6NPWMO- Tan	6" WideMount No Pipe	Tan
6NPWMO- Brown	6" WideMount No Pipe	Brown
6NPWMO- Onyx	6" WideMount No Pipe	Onyx

\*Premium Colors Available in: WoodStock Brown, Light Grey, SlateGrey, and DeepOcean Blue\*

### Performance Data

#### Product Use:

- Bathroom Exhaust & Range Hood Termination

#### Materials:

- USA Sourced 20% Talc Filled Polypropylene
- UV Inhibitor= 15,000 kJ/m2 before failure
- equal to 10-15 years in Florida sun
- Melting Point: Approx 325° F (163° C)

### General Information

#### Benefits:

- Blocks Birds and other pests from entering exhaust system without the use of cages or screens.
- Dual door design allows two back draft dampers eliminating the need for an additional back draft damper on the interior and completely seals system from outside air.
- Eight marked mounting holes for easy installation
- Low profile Design
- Dual Door has low back pressure differential and High Exhaust efficiency
- High Grade American Talc Filled Polypropylene

#### Features:

- Patented Dual Door Design
- Magnetic Door Retention

### Manufactured By:

**P-tec Products, Inc**

248 N Church St.

Zeeland, MI 49464

616-772-0659

Nopestvent.com

Home of the

**NO-PEST**  
vent

Made In USA